

NEW GLARUS

DANE COUNTY

T.4N.-R.7E.

Refer to page 57 for keyed parcels

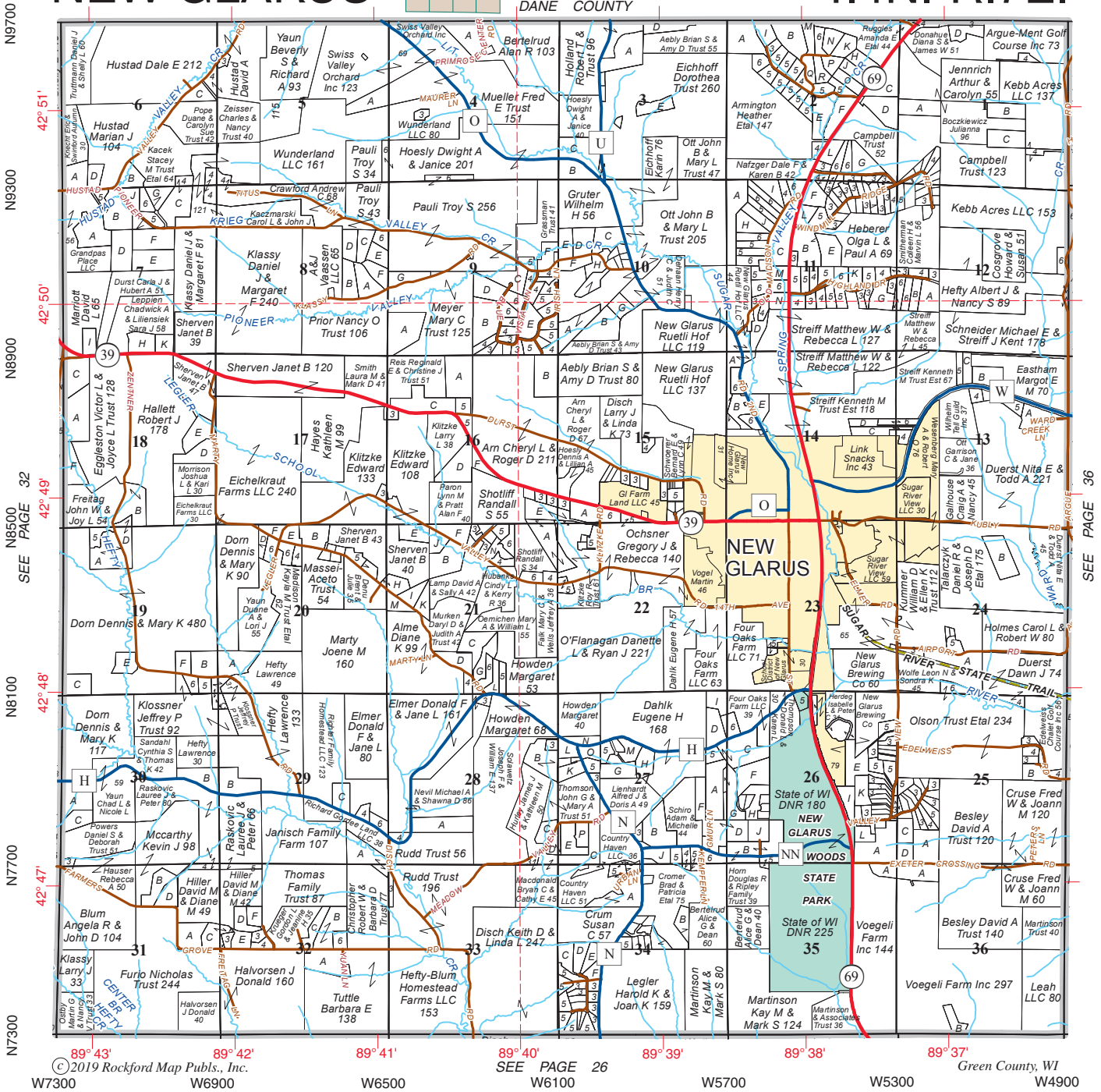

© 2019 Rockford Map Publs., Inc. SEE PAGE 26 W7300 W6900 W6500 W6100 W5700 W5300 W4900 89° 43' 89° 42' 89° 41' 89° 40' 89° 39' 89° 38' 89° 37' Green County, WI

UB&T[®]

Union Bank & Trust Company

Still Growing Together

608.424.2319 • www.ub-t.com

Your Partner in Ag for Over 100 Years!

Count on us for:

- Ag Expertise
- Ag Financing
Revolving Lines of Credit
Operating & Intermediate Loans
Real Estate Loans
- Crop & Dairy Insurance*
- Trust and Estate Planning

*NDIP *Insurance Products sold through Risk Management Agency.
 • Not a deposit or other obligation of, or guaranteed by, the bank or an affiliate of the bank;
 • Not insured by FDIC or any other agency of the United States, the bank, or affiliate of the bank
 Equal Opportunity Provider. Equal Housing Lender.